





## SPECIFICATIONS

### Structure:

RCC framed structure in M20 grade concrete for strength, durability and longevity.

### Walls:

First Class KB brick masonry in 1:6 cement mortar.

### Plastering:

18mm thick cement plaster with water proofing admixture for outer wall and 12mm thick cement plaster for inner walls.

### Flooring:

Branded Premium Vitrified tiles in living / Dining / Bedroom. Anti-skid Ceramic / Granite tiles in toilet, Kitchen and balconies.

### Painting:

Emulsion with putty surfacing for interiors and water proof weather resistant acrylic based paint for exteriors.

### Doors:

Sal wood frames treated with anti-termite chemicals, main door- skinned paneled flushed and plywood flushed doors for the rest.

### Windows:

Aluminum framed and glazed with smoke glass.

### Kitchen:

Granite platform and stainless steel sink. 2 ft high glazed tiles skirting above WT.

### Stair case:

Stainless steel railings and granite stone cladding over raisers and treads.

### Electricals:

Concealed copper wiring with modular switches and accessories.

### Plumbing:

Concealed PVC pipe with branded white ware and standard sanitary fittings such as CP faucets, showers, stopcocks, towel rods / rings, mirrors etc.

ANANYA  
ANGAN  
AT ALEKH NAGAR

THE AROMA OF A SWEET  
LIFE!

ROAD



U.NO.	AREA
1	1003 sft.
2	1019 sft.
3	756 sft.
4	744 sft.
5	1027 sft.

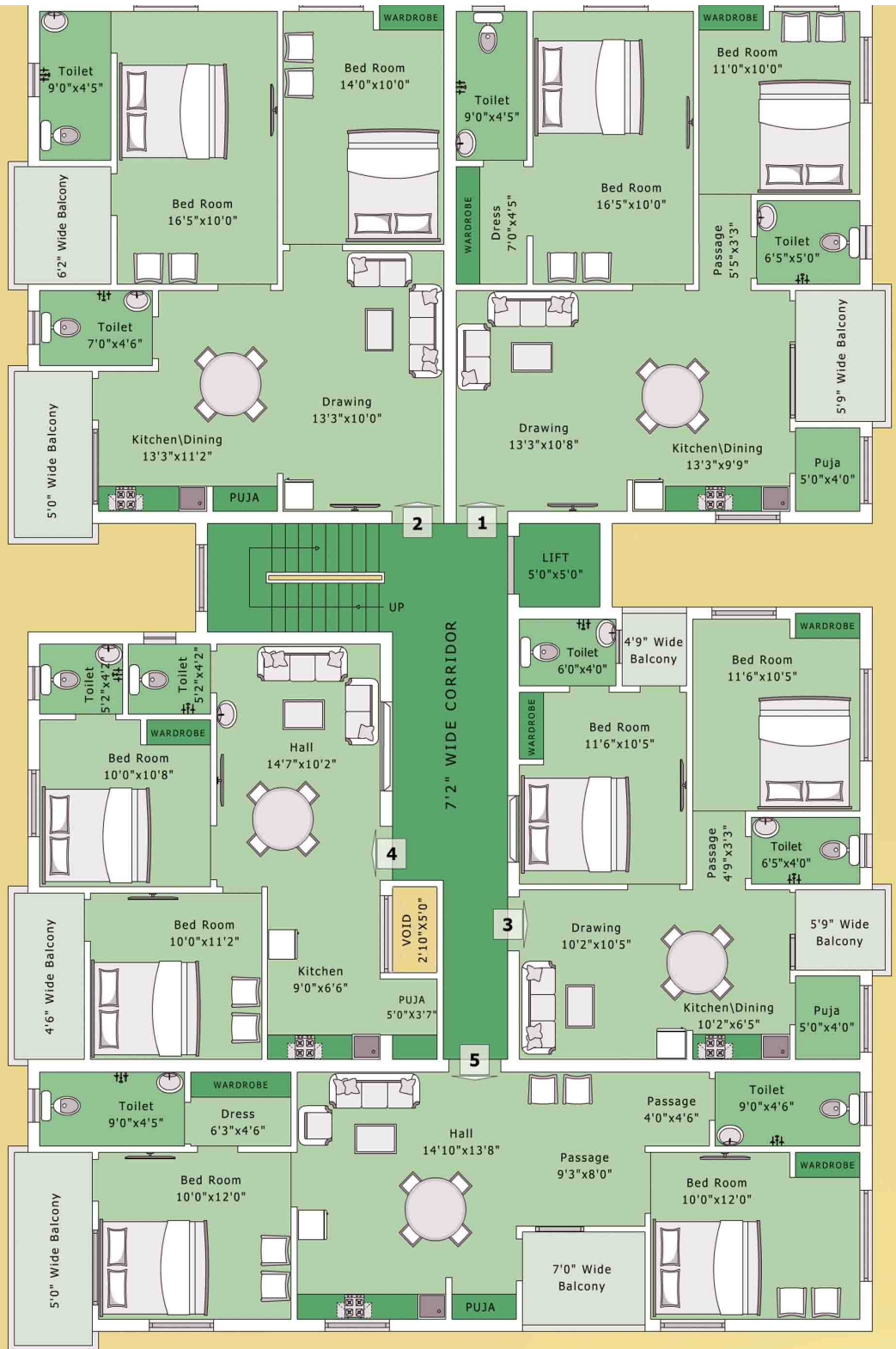



Project by:

## ANANYA LAND SCAPES & STRUCTURES

Gandhi Nagar 1st lane, Berhampur  
 PH. 9132103333, 9132115555, 7787841307

Concepts & Designed by:



**ACE ASSOCIATES**

Gandhi Nagar Main Road, Berhampur  
 PH. 94370 61210, 98618 78632, 8895238883

Disclaimer : All designs, perspectives, elevations, specifications, layout plans etc., are indicative and are subject to change. Accessories shown in some of the pictures in this brochure such as furniture, cabinet, electrical appliances, light fittings, wall & floor texture ect. are indicative/decorative and are not part of the sale offered.

## PROJECT FEATURES

- > ANANYA ANGAN is designed with a perfectly balanced combination of aesthetics and functionality based on vastu friendly architecture and offers you true value for money proposition.
- > Open area in an unspoilt, pristine natural ambience and landscaped greens.
- > Well developed 30' wide main road & good communication facility.
- > Energy efficient & Green building design concepts.
- > Common Boundary Wall and Security Post.

